

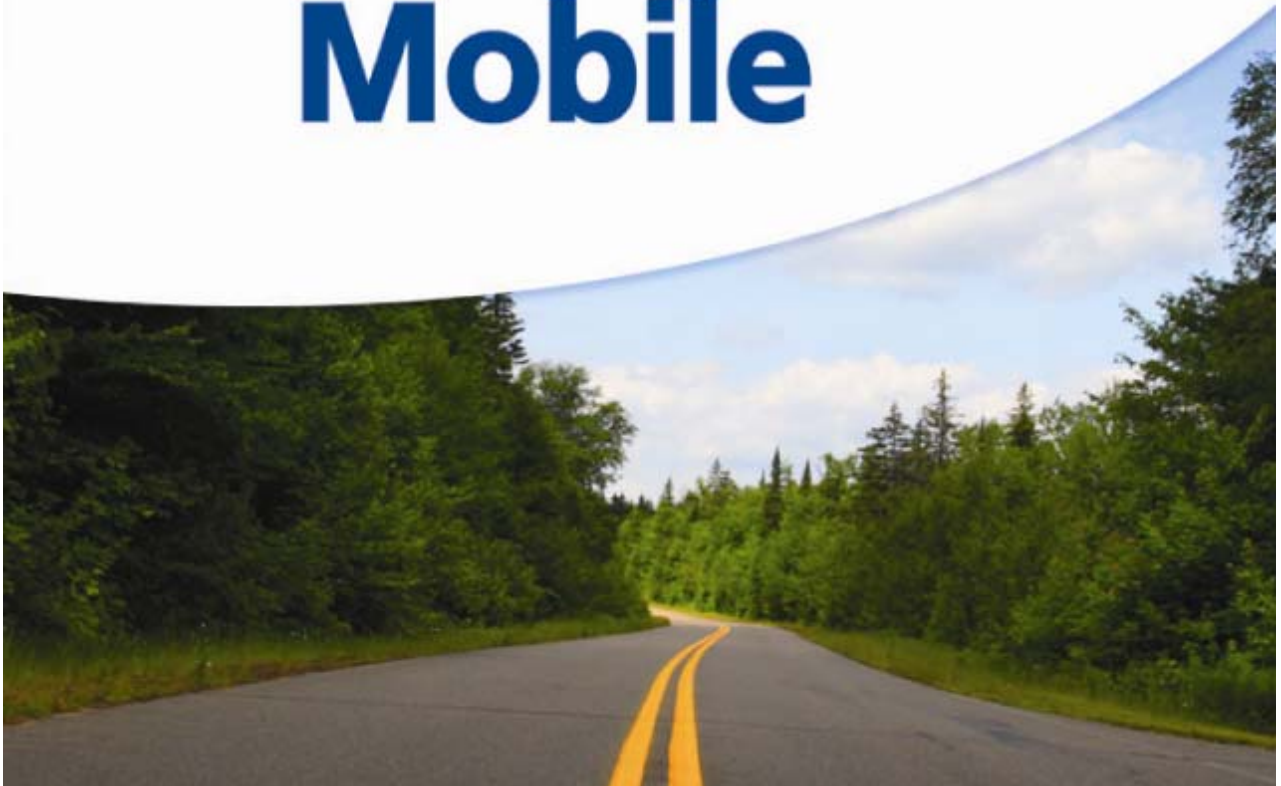

Mobile



User Guide



Product Description

AAA Mobile® is an application that makes it easy for you to access AAA information and services wherever you go.

With AAA Mobile, maps, directions, and even a helping hand are now only as far away as your wireless phone. With AAA Mobile, you can:

- Notify a AAA member roadside assistance center of your current location, so we can provide service where you need it.
- Enjoy the same capabilities as expensive in-vehicle and portable navigation systems, including audible turn-by-turn directions and automatic rerouting of missed turns.
- Use your phone to search AAA TourBook® guide travel information for nearby diamond-rated hotels and restaurants, as well as other AAA-approved points of interest.

With AAA Mobile® you will always know where you are, where you want to go, and how to get there.

Using the Application

Your Phone's Control Keys

The main control keys on your phone are:

- Left Key
- Right Key
- OK / Center Key
- CLR Key
- Scroll Pad

The CLR key is AAA Mobile®'s all-purpose "Go Back" key, used to move to previous screens and delete text input.

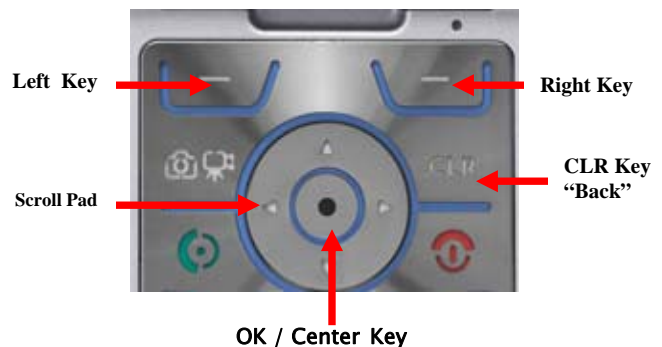



The Left Key, Right Key and OK / Center Key vary in function depending on where you are and what you are doing in AAA Mobile®. The bottom of the screen always shows the current functions associated with these keys, as seen in the illustration to the right. In this example, the Left Key activates the Roadside Service feature, the Right Key displays a list of options, and the OK / Center Key activates the selected application feature from the main menu.

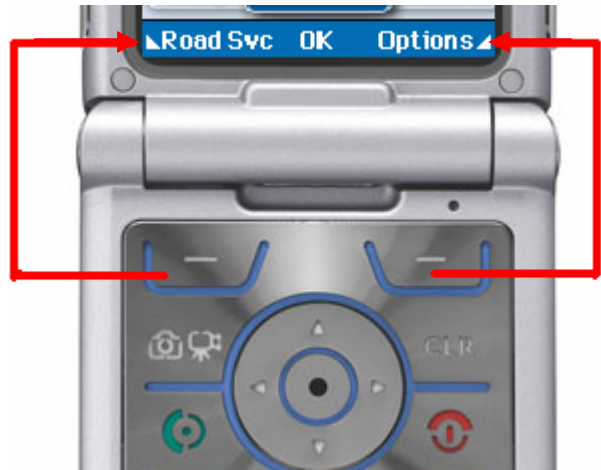

The Scroll Pad is used for such tasks as scrolling maps, moving between items in a list or scrolling through a set of driving directions. Directional arrows may also be displayed to indicate that the Scroll Pad can be used for the selected item on the screen.





Enabling the Location Capability on Your Phone

To use AAA Mobile[®], your phone's location capability must first be enabled. This needs to be done only once.

1. From the opening screen on the handset, press OK to select "Menu."
2. Use the Scroll Pad to scroll right to the "Settings & Tools" category.
3. Scroll down to "System" and press OK.
4. Scroll down to "Location" and press OK.
5. Select "Location On" and press OK.

The "**Location On**" icon () appears at the top of the screen to confirm the setting is correct.

Note: This setting does not enable anyone or any application to actually retrieve the location of the phone. You must still grant AAA Mobile[®] access to the location capability before it can acquire the phone's location. The first time you run AAA Mobile[®], you will be prompted to grant this permission to the application.

Running AAA Mobile[®]

To run AAA Mobile[®] from the handset's main screen:

1. Press the OK / Center Key to open the phone's menu.
2. Press on the left or right side of the Scroll Pad to select the "Get It Now" tab.
3. Press on the bottom of the Scroll Pad until the "Get Going" category is highlighted, then press the OK / Center Key to open the category listing. NOTE: On some Verizon handsets, the category name may be displayed as "Tools on the Go."
4. Press on the bottom of the Scroll Pad until AAA Mobile is highlighted, then press the OK / Center Key to start the application.



Customizing AAA Mobile® with Preferences

You can personalize your AAA Mobile® experience by setting your preferences for how it looks and serves your needs. To view your preferences, at the main screen press “Options” (Right Key) and select “Preferences.” The categories of preferences are:

- **General:** Control overall map and application preferences, such as whether to show “Place” icons on maps and whether to use metric or English units.
- **History:** Clear favorites or recently used search results.
- **Navigation:** Control how your trip is planned (route type, roads to avoid, etc.) and how AAA Mobile® guides you (voice prompt selection and volume, when to show next turn, etc.).
- **Turn Maps:** Control whether to show maps of the next turn on your route, and how you want the maps displayed.
- **Menu Style:** Change the look of the application's main menu.
- **User Information:** Manage your AAA member information and phone number.



Local Search: Finding Places of Interest

Use **Local Search** to look up AAA TourBook® guide travel information, including nearby Diamond Rated® hotels and restaurants, as well as other points of interest (POI) such as businesses, attractions, and events. Narrow your search by entering one or more of the following:

- With the **Category** field highlighted, press the Scroll Pad to the right to select the type of POI you want to find.
 - The “Dining” category has several subcategories that allow you to search for a specific cuisine or restaurant type.
 - The “Show Your Card & Save®” category has several subcategories of goods and services that provide AAA discounts.
- Enter part or all of a desired destination’s name in the **What** field. As you type into this field, it may automatically display text that you previously entered in this field that matches the letters you entered. If you wish to use this matched text, simply press on the right side of the Scroll Pad and the field will be updated with the matched text.
- Leave the **Where** field at “My GPS Location” to center the search on your current location. Highlight the **Where** field and press the Scroll Pad to the right to select from a variety of different locations for your search:
 - a street address
 - an intersection
 - an airport
 - a recently used location
 - a location you previously stored as a “Favorite.”

Press “FIND” (OK/Center Key) to perform the search.

AAA Mobile® will display up to the first ten matching points of interest. If an item in the results list has AAA TourBook® guide travel information, the AAA logo will be displayed, as well as the AAA Diamond rating and Show Your Card & Save® logo, if these are available for the item. To view additional matching results, simply press the Scroll pad up or down to highlight “More Results” (the last item in the list) and press “VIEW” (OK/Center Key).

To view detailed information about a point of interest, highlight it in the results list and press “VIEW” (OK/Center Key).

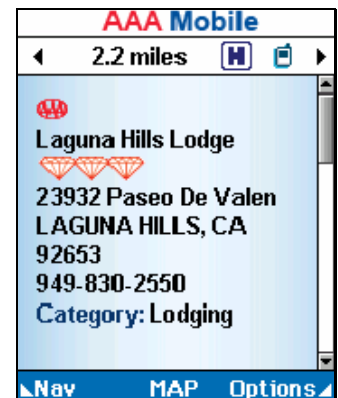
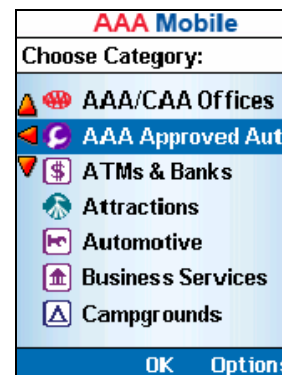
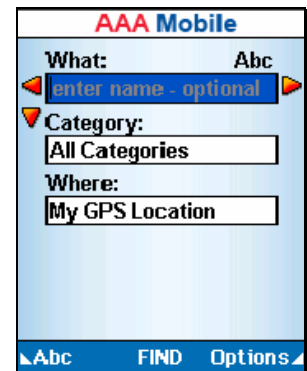



Navigation: Getting Driving Directions

The Navigation feature allows you to receive audible turn-by-turn directions to a destination of your choice. To get started, choose “Navigation” from the main menu then select from the following:

1. **Find Destination:** Get directions to a location you specify. You can search for a point of interest, enter an address or intersection, choose an airport, or choose from your “Favorites” or “Recent Searches.”
2. **Plan Trip:** Get directions between any two points you specify. Use this to set both the start and end locations for your trip. This allows you to plan ahead or get directions for a friend.
3. **Home:** Get directions to the favorite, designated as your home address (which you can specify using the “Favorites” main menu feature). This is a quick shortcut so you can always find your way home, no matter where you are.
4. **Work:** Get directions to the favorite, designated as your work address (which you can specify using the “Favorites” main menu feature). This is a quick shortcut so you can always find your way to work, no matter where you are.

Once you’ve selected a destination to which you wish to receive directions, AAA Mobile® downloads the step-by-step directions and displays the first step in detail. If you chose to navigate to a destination, the “Navigation” screen is displayed. If you chose the “Plan Trip” option to plan ahead and receive directions, the “Look Ahead” screen will display.

Note: you can always get to the “Look Ahead” screen from the “Navigation” screen by pressing right on the Scroll Pad.



Navigation: Key Features

The “Navigation” screen keeps you informed on your trip's progress. At each step you will receive audible turn-by-turn directions as the turn approaches. To repeat voice prompted directions, select “TALK” by pressing the OK/Center Key.

Press right or left on the Scroll Pad to move forward and backward through the steps in your trip.

Press down on the Scroll Pad on any step to see a map of the turn point highlighting your location. This allows you to see yourself approaching a turn. Press up on the Scroll Pad to hide the turn point map and return to the regular “Navigation” screen.

Press “Map” (Left Key) to display a map of your entire route. The map will show you from start to end the route and direction you are headed in. In the map you have the ability to “Zoom” in to a detailed “Street View” or out as far as a “Nation View.”

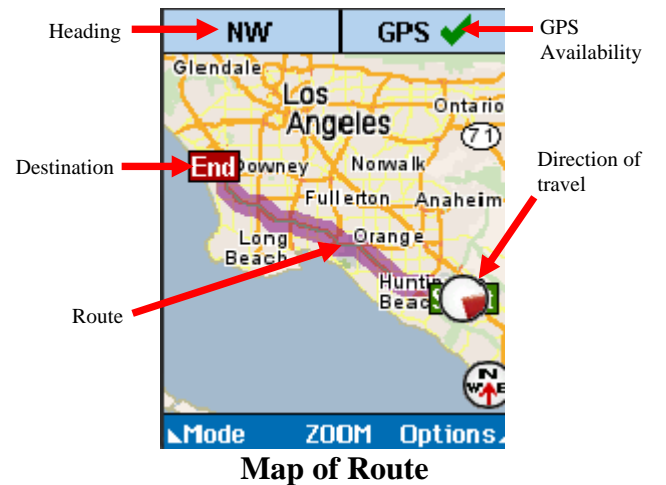
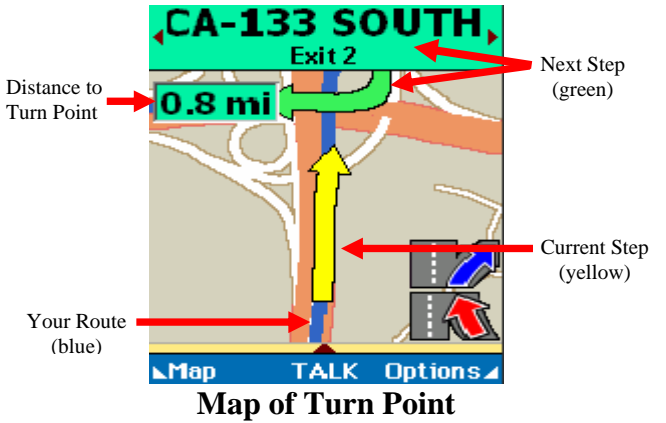
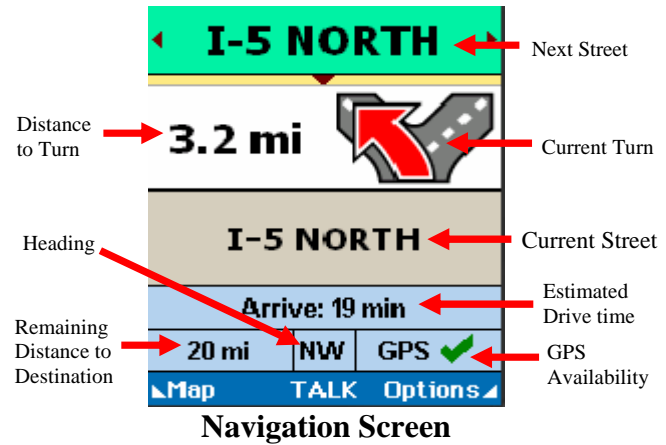



The “Look Ahead” screen shows you details of each step in your trip, including the next turn’s name and distance, as well as other information.

You can hear audible instructions for any step in your trip by selecting “TALK” (OK/Center Key).

Press right or left on the Scroll Pad to scroll forward and backward through the steps in your trip. Press down on the Scroll Pad at any step to see a map of the turn point.

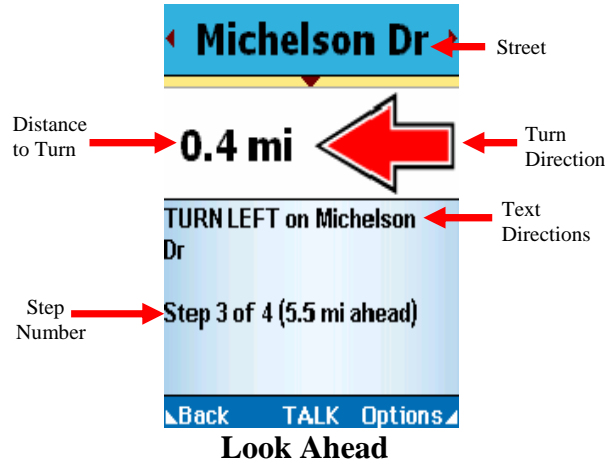

The “Map of Step” option can be selected when looking at a “Look Ahead” step by clicking “Options” (Right Key) then selecting “Map of Step.” This option will show you a map of the next step in your trip.

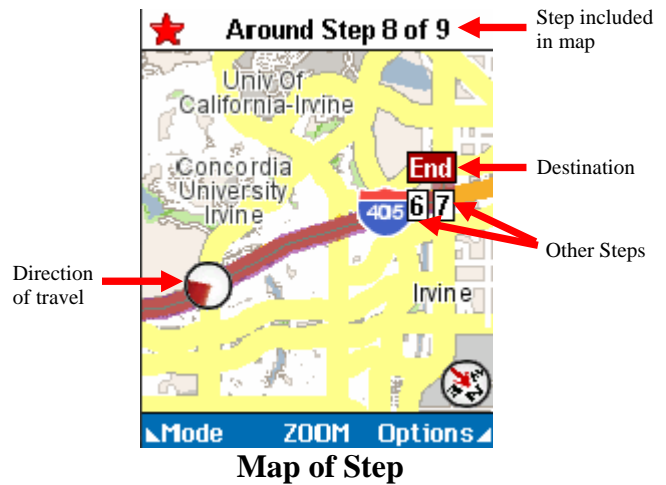



Roadside Service: Initiating a Call to AAA

This exclusive feature of AAA Mobile® allows you to contact AAA and get help where you need it when you experience car troubles.

- AAA Mobile® will store your AAA member number and mobile telephone number so that it can quickly be sent to AAA when you use the Roadside Service feature.
- AAA Mobile® Roadside Service will attempt to determine your current location and put you in contact with the appropriate AAA roadside assistance call center.
- If you do not enter your AAA member number the first time you run AAA Mobile®, you can go back later and enter this information, so that it can be used by the Roadside Service feature.

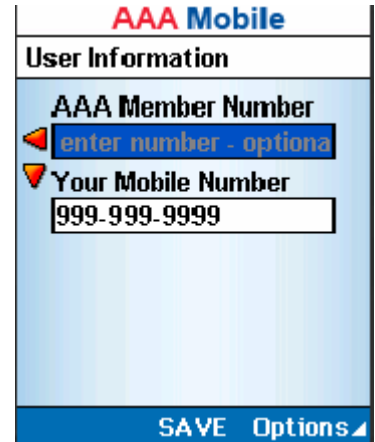



Maps: Getting a Map of Any Location

The “Maps” option from the main screen allows you to select any location and view a map of the surrounding area. It provides you the following options:

1. **Find Location:** Display a map of a location you specify. You can search for a point of interest, enter an address or intersection, choose an airport, or choose from your “Favorites” or “Recent Searches.”
2. **Where Am I?:** Display a map of your current GPS location.
3. **Follow Me Map:** Display a map which moves with you, so you can always see your current location.

Once you have a map, you can zoom in and out or scroll in any direction by using the OK/Center Key and Scroll Pad buttons.

The “ID-Cursor Mode” can be activated by pressing “Mode”(Left Key). You can then use the Scroll Pad to move a cursor on the map and mark a place on the map that you would like to use as a reference point. Once the location has been selected you press “Options” (Right Key) to perform any of the following actions:

1. Drive to the location
2. Search around the location
3. Center the map on the location





My Places: Shortcuts to Favorite Places and Recent Searches

”My Places” gives you quick access to places you’ve saved and places you recently entered manually, viewed or to which you have navigated.

- “Recent Searches” shows places that were recently entered, viewed or to which you navigated. Select a location from the list to see its information, then display a map, navigate to it, or press “Options” (Right Key) to add it to “Favorites” or perform other functions. The “Search” box allows you to quickly locate an item in your “Recent Searches” list.
- “Favorites” lists locations you have saved. Select “Add New Favorite” to enter a new location. Or, select a location from the list to view its information, then display a map, navigate to it, or press “Options” (Right Key) to edit its settings or perform other functions. The “Search” box allows you to quickly locate an item in your “Favorites” list.
- “Home” and “Work” are special names for favorite locations. The favorites with these names can be accessed quickly throughout the application.



My Places Menu

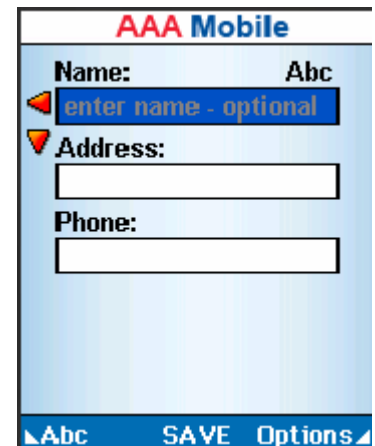

Add New Favorite

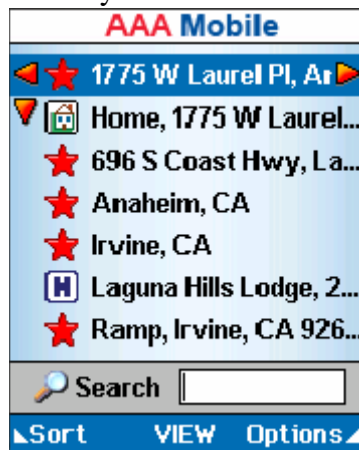

Recent Searches



Favorites Search



This section of this page is intentionally left blank



Tips and Tricks

1. Whenever you need to specify a location in AAA Mobile[®], you can choose from the following options:
 - a. A specific address. Note: You can enter the full address, just the city and state, or just the zip code.
 - b. An airport. You can enter the three-letter airport code, the partial name of the airport, or select from the list of airports.
 - c. An intersection of two streets.
 - d. Your current location.
 - e. Places you have recently entered, viewed or to which you have navigated.
 - f. Places you have saved as favorites in AAA Mobile[®].
2. To get directions to a point of interest, such as a business, first use “Local Search” to find the place, then use the “Nav” option (Left Key) or select “Get Directions To” from the “Options” menu (Right Key).
3. You can get to the “Look Ahead” screen from the “Navigation” screen by pressing right on the Scroll Pad. Go back to the “Navigation” screen by pressing left on the Scroll Pad.
4. From the “Navigation” screen you can view the “Trip Summary,” including start and end locations, total trip time and distance, by pressing left on the Scroll Pad. Go back to the “Navigation” screen by pressing right on the Scroll Pad.
5. When viewing detailed information about a point of interest you can scroll through the other places in your Local Search results list by pressing left and right on Scroll Pad.
6. Press the “Send” key from the Local Search results list or point of interest detail screen to place a phone call to the selected point of interest without having to exit the application.

This section of this page is intentionally left blank



Disclaimer

Upon acceptance of the AAA Mobile® terms and conditions, you will become a subscriber to AAA Mobile® as described and subject to the terms of your Customer Agreement and Calling Plan with your wireless carrier.

If you wish to terminate your subscription to AAA Mobile®, please contact your wireless carrier. No refunds shall be granted for any fees paid in advance. Upon termination you will no longer have access to data, locations and other material you previously stored.

AAA Mobile® provides route information to help you reach your destination. Due to road conditions, some recommendations may not be appropriate. Always obey all traffic laws as posted and exercise your own good judgment. When in your vehicle, always ensure that you are parked in a safe location before executing searches, entering destinations or using AAA Mobile® features that require you to look at the phone screen or interact with the phone keypad.

AAA Mobile® is being made available with the understanding that all data is provided with no warranties, expressed or implied, concerning accuracy, reliability, or suitability for a given purpose. Neither AAA nor your wireless carrier shall be liable regardless of the cause or duration, for any errors, inaccuracies, omissions, or other defects in the information, or for any delay or interruption in the transmission thereof, or for any claims or losses arising from or occasioned thereby. The end user assumes the entire risk as to the quality of the data provided by AAA Mobile®.

Copyright © 2007 American Automobile Association, Inc. All rights reserved. AAA, AAA Mobile, the AAA logo and the AAA Mobile logo are registered trademarks of the American Automobile Association, Inc. All data identified by the AAA logo () provided by AAA Mobile® are the property of the American Automobile Association, Inc. and are being provided as-is and for use solely within of the AAA Mobile® application. All other uses of this information are prohibited.

Map Data Copyright © 2005 – 2007 NAVTEQ. All rights reserved.



NIM and the Powered By NIM logo are trademarks of Networks In Motion, Inc.

Patents Pending.



This page is intentionally left blank